

TECHNICAL DETAILS

DC TACHOGENERATOR Model: E- K10A2

Voltage Per 1000 r/min	80 V \pm 5 %
I max	180 mA @ 400V
Max O/p Voltage	400VDC
Max Speed Range	5000 RPM
Armature Resistance @25 Deg.C	95 Ω
Max Load Impedance	2200 Ω
Max ripple Voltage	< 0.5%
Voltage Regulation	2.5%
Linearity	< 0.2%
Class of Insulation	F
Carbon Brush	2 Nos Per Arm
Brush Grade	Electro Graphite
Protection	IP 44 Totally Enclosed
Connections	Cable
Ambient Temperature	60 Deg.C
Weight (Flange Type)	3 Kgcm

DIMENSIONS:

DC Tachogenerator Model:E- K10A2

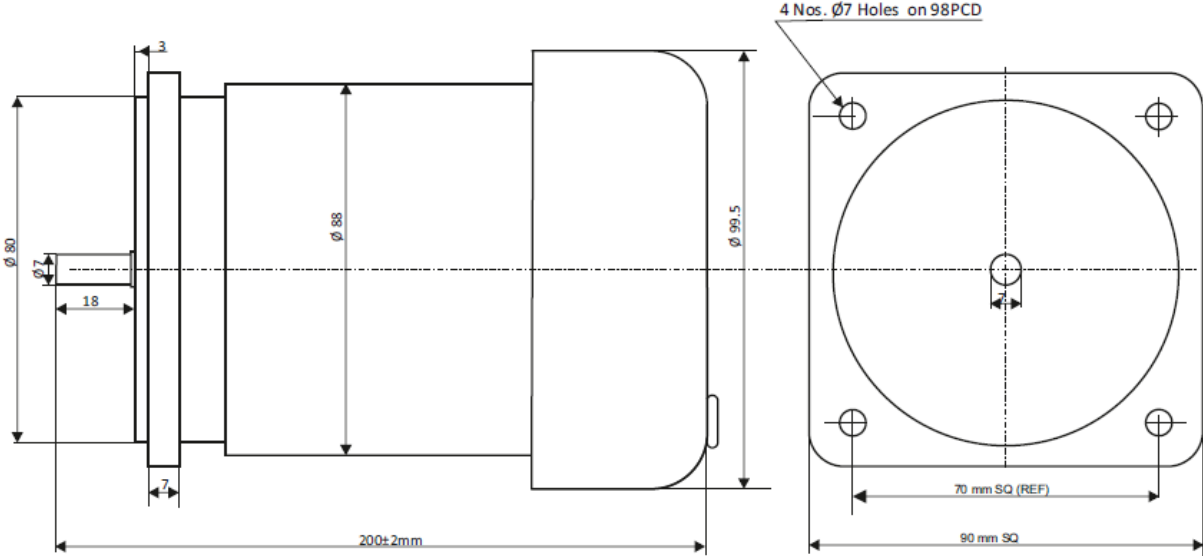

OUTPUT : 80V at 1000RPM
I max : 180mA
Max. Speed : 6000 RPM